

2009 International Residential Code Errata

(Portions of text and tables not shown are unaffected by the errata)

1st through 7th PRINTING (November 7, 2014)

CHAPTER 7 WALL COVERING

Table R702.1(3)

TABLE R702.1(3)
CEMENT PLASTER PROPORTIONS, PARTS BY VOLUME

COAT	CEMENT PLASTER TYPE	CEMENTITIOUS MATERIALS				VOLUME OF AGGREGATE PER SUM OF SEPARATE VOLUMES OF CEMENTITIOUS MATERIALS ^b
		Portland Cement Type I, II or III or Blended Cement Type IP, I (PM), IS or I (SM)	Plastic Cement	Masonry Cement Type M, S or N	Lime	
First	Portland or blended	1			$\frac{3}{4} - 1\frac{1}{2}$ ^a	$2\frac{1}{2} - 4$
	Masonry			<u>1</u>	1	$2\frac{1}{2} - 4$
	Plastic		1			$2\frac{1}{2} - 4$

2009 International Residential Code Errata

(Portions of text and tables not shown are unaffected by the errata)

1st through 7th PRINTING (Posted: 09-26-13)

CHAPTER 7 WALL COVERINGS

FIGURE 703.2.2

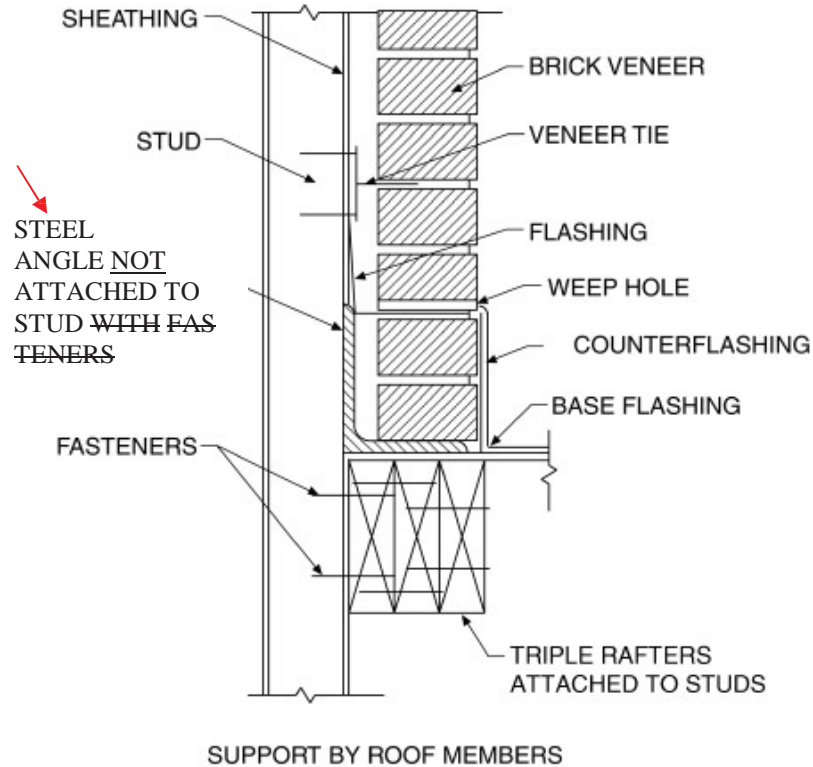

FIGURE R703.7.2.2
EXTERIOR MASONRY VENEER SUPPORT BY ROOF MEMBERS

2009 International Residential Code Errata

(Portions of text and tables not shown are unaffected by the errata)

1st and 2nd PRINTING (JULY 14, 2011)

CHAPTER 7 WALL COVERING

**TABLE R703.4
WEATHER-RESISTANT SIDING ATTACHMENT AND MINIMUM THICKNESS**

SIDING MATERIAL	NOMINAL THICKNESS ^a (inches)	JOINT TREATMENT	WATER-RESISTIVE BARRIER REQUIRED	TYPE OF SUPPORTS FOR THE SIDING MATERIAL AND FASTENERS ^{b,c,d}					
				Wood or wood structural panel sheathing	Fiberboard sheathing into stud	Gypsum sheathing into stud	Foam plastic sheathing into stud	Direct to studs	Number or spacing of fasteners
Fiber cement panel siding ^q	5/16	Note q	Yes Note u	6d common corrosion-resistant nail ^f	6d common corrosion-resistant nail ^f	6d common corrosion-resistant nail ^f	6d common corrosion-resistant (42" x 0-0.113") nail ^{f,v}	4d common corrosion-resistant nail ^f	6" o.c on edges, 12" o.c on intermed. studs
Fiber cement lap siding ^s	5-16	Note s	Yes Note u	6d common corrosion-resistant nail ^f	6d common corrosion-resistant nail ^f	6d common corrosion-resistant nail ^f	6d common corrosion-resistant (42" x 0-0.113") nail ^{f,v}	6d common corrosion-resistant nail or 11 gage roofing nail ^f	Note t

R703.11.2.2 Basic wind speed exceeding 90 miles per hour or Exposure Categories C and D.....adjusted for height and exposure using ~~Section~~ Table R301.2(3). The design.....

2009 International Residential Code Errata

(Portions of text and tables not shown are unaffected by the errata)

1st and 2nd PRINTING (SEPTEMBER 14, 2009)

CHAPTER 7 WALL COVERING

TABLE R703.4 WEATHER-RESISTANT SIDING ATTACHMENT AND MINIMUM THICKNESS

..... Note w. Adhered masonrySections 6.1 and 6.3 of ~~ACI 530/ASCE 5/TMS 402~~ TMS 402/ACI 530/ASC 5.